

Terboinox d.o.o.

EXPORT-IMPORT

Garolla priključci



Garolla Fitingen

Garolla fittings

POKROV GAROLLA
 DECKEL FÜR GAROLLA
 COVER FOR GAROLLA

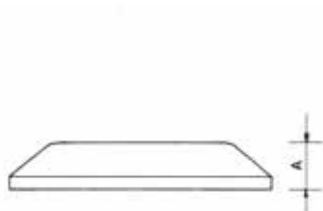

DN	A	B	C	W.Nr.:1.4301/1.4401 AISI 304 / AISI 316
40	15			•
50	17			•
60	17			•
70	17			•
80	17			•
100	17			•
120	18			•

VARILNI PRIKLJUČEK GAROLLA
 EINSCHWEISSSTUTZEN MIT GAROLLA ENDE
 WELDING PART WITH GAROLLA END

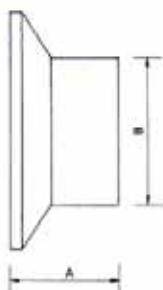

DN	A	B	C	W.Nr.:1.4301/1.4401 AISI 304 / AISI 316
40	26	42,4		•
50	28	48,3		•
60	31	60,3		•
70	33	76,1		•
80	33	80		•
100	40	101,6		•
120	40	124		•

OBJEMKA ZA GAROLLA PRIKLJUČEK

KLAMMER

CLAMP

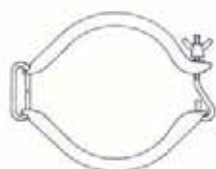

DN	A	B	C	W.Nr.:1.4301/1.4401 AISI 304 / AISI 316
40				•
50				•
60				•
70				•
80				•
100				•
120				•

NASTAVEK ZA CEV GAROLLA

SCHLAUCHSTUTZEN MIT GAROLLA ENDE

HOSE CONNECTION WITH GAROLLA END

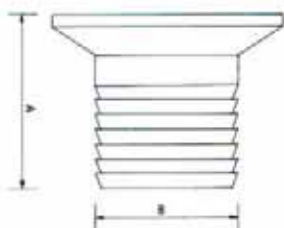

DN	A	B	C	W.Nr.:1.4301/1.4401 AISI 304 / AISI 316
40	60	40		•
50	70	50		•
60	80	60		•
70	85	70		•
80	90	80		•
100	105	100		•
120	125	120		•

TESNILO
DICHTUNG
SEAL RING

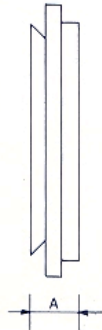

DN	A	B	C	W.Nr.:1.4301/1.4401 AISI 304 / AISI 316
40	13			•
50	13			•
60	13			•
70	14			•
80	14			•
100	14			•
120	16			•

PRIKLJUČEK GAROLLA Z NOTRANJIM NAVOJEM
MUFFE MIT GAROLLA ENDE
SOCKET NIPPLE WITH GAROLLA END



DN	A	B	C	W.Nr.:1.4301/1.4401 AISI 304 / AISI 316
40	40	1"		•
	40	1" j		•
	45	1" S		•
50	45	1" j		•
	45	1" S		•
	50	2"		•
60	50	1" S		•
	50	2"		•
	50	2" S		•
70	50	2"		•
	50	2" S		•
	50	3"		•
80	50	2" S		•
	50	3"		•
	50	4"		•
100	55	2" S		•
	55	3"		•
	55	4"		•

PRIKLJUČEK GAROLLA Z ZUNANJIM NAVOJEM
ANSCHWEISSNIPPEL MIT GAROLLA ENDE
THREADED NIPPLE WITH GAROLLA END

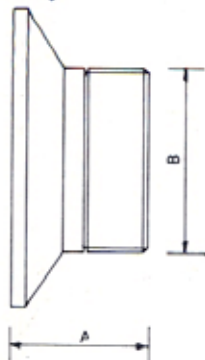

DN	A	B	C	W.Nr.:1.4301/1.4401 AISI 304 / AISI 316
40	40	1"		•
	40	1" j		•
	45	1" S		•
50	45	1" j		•
	45	1" S		•
	50	2"		•
60	50	1" S		•
	50	2"		•
	50	2" S		•
70	50	2"		•
	50	2" S		•
	50	3"		•
80	50	2" S		•
	50	3"		•
	50	4"		•
100	55	2" S		•
	55	3"		•
	55	4"		•

CEVNI LOK GAROLLA
ROHRBOGEN MIT GAROLLA ENDEN
ELBOW WITH GAROLLA ENDS

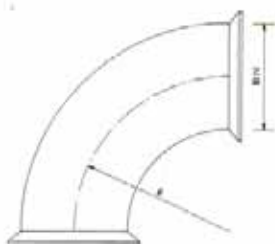

DN	A	B	C	W.Nr.:1.4301/1.4401 AISI 304 / AISI 316
40				•
50				•
60				•
70				•
80				•
100				•
120				•

T – KOS GAROLLA

T – STÜCK MIT GAROLLA ENDEN
TEE WITH GAROLLA ENDS

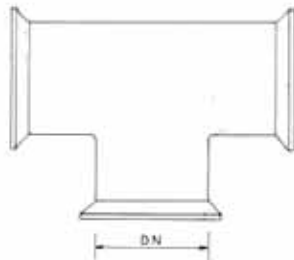

DN	A	B	C	W.Nr.:1.4301/1.4401 AISI 304 / AISI 316
40				•
50				•
60				•
70				•
80				•
100				•
120				•

PODALJŅAN REDUCIR GAROLLA

REDUZIERSTÜCK VERLÄNGT MIT GAROLLA
REDUCER ELONGATED WITH GAROLLA ENDS

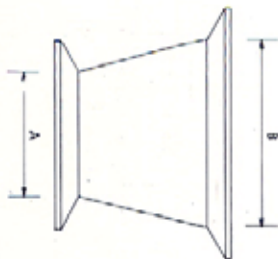

DN	A	B	C	W.Nr.:1.4301/1.4401 AISI 304 / AISI 316
	40	50		•
	50	60		•
	50	70		•
	50	80		•
	60	70		•
	60	80		•
	60	100		•
	70	80		•
	70	100		•
	80	100		•
	80	120		•
	100	120		•

REDUCIR GAROLLA
 REDUZIERSTÜCK MIT GAROLLA ENDEN
 REDUCER WITH GAROLLA ENDS

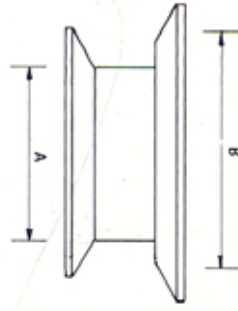

DN	A	B	C	W.Nr.:1.4301/1.4401 AISI 304 / AISI 316
	40	50		•
	50	60		•
	50	70		•
	50	80		•
	60	70		•
	60	80		•
	60	100		•
	70	80		•
	70	100		•
	80	100		•
	80	120		•
	100	120		•